

## Aquila 54 Yacht Power Catamaran Specifications

Length overall w/swim platform (exc. anchor roller)	<b>16.5 M / 54' 2"</b>
Beam overall	<b>7.68 M / 25' 2"</b>
Height above waterline w/ hard top (excluding electrics and electronics)	<b>6.15 M / 20' 2"</b>
Height above waterline w/ hard top (including light and radar mast)	<b>7.43 M / 24' 4"</b>
Draft including propeller (approximate - will vary depending on load)	<b>1.37 M / 4' 6"</b>
Light displacement with D6 Volvo Penta	<b>23,300 KG / 52,367 LB</b>
Fully loaded displacement with D8 Volvo Penta	<b>30,000 KG / 66,138 LB</b>

## Tankage

Fuel tank (standard)	<b>2,200 L / 581 GAL</b>
Fuel tank (reserve)	<b>720 L / 190 GAL</b>
Water tank (standard)	<b>1,000 L / 238 GAL</b>
Holding tank (total)	<b>340 L / 90 GAL</b>

## CE certification *(internationally recognized)*

Cat. A (Ocean)	<b>12 PAX</b>
Cat. B (Offshore)	<b>12 PAX</b>
Cat. C (Coastal)	<b>20 PAX</b>
Cat. D (Inland/Sheltered)	<b>30 PAX</b>

## Accommodation

Cabins	<b>3 / 4 / 5</b>
Heads with separate showers	<b>3 / 4 / 5</b>
Sleeps up to	<b>10+</b>
Maximum Passengers	<b>30</b>

## Propulsion

Standard	<b>2x D6 380 HP VOLVO PENTA INBOARD DIESEL</b>
Optional	<b>2x D6 480 HP VOLVO PENTA INBOARD DIESEL</b>
Optional	<b>2x 550 HP CUMMINS QSB6.7 INBOARD DIESEL</b>

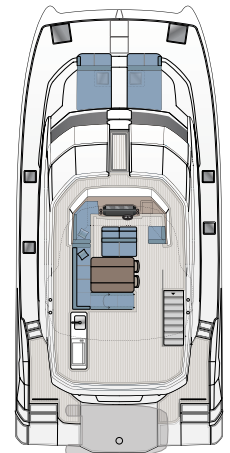

**STANDARD  
FLYBRIDGE**

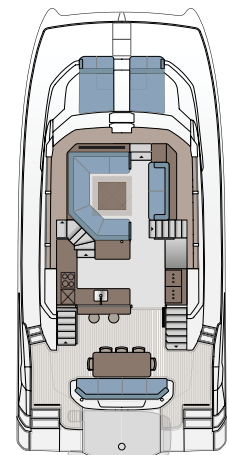

**STANDARD  
MAIN DECK**

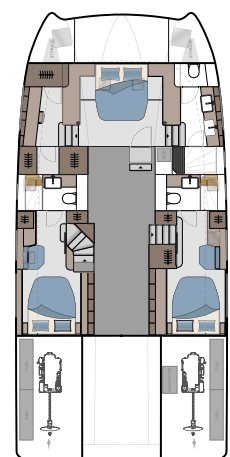

**STANDARD  
3-CABIN**

All specifications and options are subject to change by Sino Eagle Yachts at their sole discretion. Performance is purely indicative and not a contractual commitment. Performance is subject to many variances outside the control of Sino Eagle Yachts. Specifications and graphics in this brochure are non-binding and customer must enter into contractual agreement with the Dealer or Agent of Record.

## Construction

Hull and deck material	<b>InfusiCore vinyl ester resin infused throughout</b>
Bulkhead and reinforcing	<b>InfusiCore vinyl ester resin infused throughout</b>
Core materials (vary in density)	<b>PVC</b>
Gel coat of hull	<b>NPG</b>
All main FRP components	<b>Vinyl ester resin infused throughout</b>
Bulbous Bows	<b>Molded and attached; breakaway safety</b>
Hull and deck windows	<b>Tempered glass meeting ISO standards</b>

## Features

- An exceptional performing and seaworthy hull shape providing first in class stability and comfort
- Expansive outdoor living and entertaining spaces along with luxurious interior styling and amenities
- Plenty of shade on flybridge via fiberglass hardtop with 316L polished stainless steel supports
- Integrated bar area connecting social areas between aft cockpit and salon/galley
- Comfortable seating throughout for up to thirty (30) people onboard
- Direct bow access from central steps leading from flybridge to bow area
- FUSION multi-zone audio system with Fusion speakers and Bluetooth connectivity
- Premium comforts provided by way of three (3) cabins each with their individual walk in toilet with separate shower

## Interior Layout

- Full beam master suite including full size closet, master head with walk in shower and fresh water electric flush toilet
- Guest cabins including full size head with walk in shower and fresh water electric flush toilet
- Large salon area with ample comfortable seating
- Large galley area with full size refrigerator/freezer and common household amenities

## Hull and Deck Features

- Six (6) opening deck hatches carefully positioned to enhance ventilation in cabins
- Three (3) opening port hatches installed in hull side windows of heads
- Custom built PVC rubrail with 316L stainless steel insert offering all around protection
- Custom solid deck railings in 316L stainless steel
- Two (2) comfortable and protected bow seats integrated into deck railing
- Ten (10) Mooring cleats in solid 316L polished stainless steel thru bolted
- Deck fill plates in 316L stainless steel: water (2); fuel (2); waste(3)
- Stainless steel bow roller for secondary anchor

- Anchor locker with 1700 watt windlass including handheld remote control with custom chain lock
- Well placed ergonomic handrails in 316L stainless steel ensuring secure movement onboard
- Forward access steps from flybridge to bow
- Ergonomic transom steps for easy boarding and comfortable lounging off stern
- Transom boarding rails in 316L stainless steel; located outboard of aft steps
- High visibility LED navigation lights, running lights and anchoring light
- Engine ventilation intakes with FRP cowling cover
- Integrated manual retractable swim ladder in 316L stainless steel
- Large starboard and port bow lockers with easy lift gas hinges for fender or gear storage; waterproof
- Self draining storage locker in aft cockpit floor
- Aft cockpit, flybridge and side decks all self draining
- Aft cockpit bar area with two (2) stainless steel bar stools
- Engine access lockers with easy lift gas hinge allowing easy access to engine room
- Aft cockpit with expansive hinging window and door opening to galley
- Aft cockpit seating area with dining table which comfortably seats ten (10)
- Forward bow seating for relaxing and socializing
- Integrated aft side boarding step in hull with 316L stainless steel handrail
- Large spacious foredeck for sunbathing
- LED downlighting in aft cockpit
- Variable temperature stern shower located at port aft steps

## Flybridge

- Portugese style flybridge with walk around forward of windscreen
- Exceptional flybridge access from two (2) stairway locations
- Main access from aft cockpit
- Handrails conveniently located all around flybridge for secure movement
- Forward flybridge access via integrated steps
- Forward fixed glass center windscreen with four (4) tempered glass panels
- Windshield wiper with fresh water supply and variable speed control at helm
- Electronic engine double lever throttle and gearshift control
- Variable position stainless steel steering wheel
- Hydraulic steering
- Compass at helm station
- Four (4) marine waterproof 6" 200w speakers located in hardtop
- Spacious and comfortable helm seat for two (2) people with upholstered seat and backrest
- Comfortable forward facing seats port and starboard adjacent of helm station
- Flybridge table with fold down extensions comfortably seating nine (9) people
- Upholstered flybridge cushions and backrests
- Wet bar located aft deck area incorporating Corian work surface, sink with hot and cold faucet
- Large storage area under wet bar with two (2) access doors (optional location for fridge and ice maker)
- Dedicated life raft storage locker at transom area with easy launch
- Lifejacket and safety gear storage under aft cockpit seats
- Fourteen (14) cup holders located in various areas around flybridge

## Engine Room

Engine exhaust to reduce engine emission noise  
 Automatic fire suppression heat activated system with alarm monitors at helm station  
 Engine room insulation (50mm) flame retardant polyurethane foam covered with metalized polyester film  
 316L stainless steel engine supports  
 Engine room lighting  
 Automatic electric bilge pump in each engine room  
 Excellent all around engine and systems access for ease of maintenance  
 Two (2) hydraulic steering cylinders with Optimus EPS power steering pumps

## Engine Control

Electronic engine double lever throttle and gearshift control  
 Volvo Electronic Vessel Control (EVC) 4" display at helm station  
 Electronic start/stop switches at helm station with E-Key protection

## Underwater Gear

Engine V-drive transmission for compact efficiency  
 Propeller tunnels for reduced draft and maximum efficiency  
 Four (4) blade bronze propellers  
 Propeller shaft – machined stainless steel  
 Rudders and tiller arm in 316L stainless steel with FRP tube  
 Shut off valves on all salt water intakes in engine rooms  
 Sea water strainers  
 Watertight self aligning dripless shaft seal with 316 stainless steel housing and self aligning teflon bearing  
 Extended bronze P-bracket for maximum propeller protection  
 Sacrificial keel forward of drive train for added running gear protection

## Technical Features

Bilge pump warning lights  
 Instrument panels  
 Steering, tilt wheel  
 Steering wheel, stainless steel

## Salon Area

Excellent all around visibility from salon seating  
 Shatter-proof windows with external overhangs offering excellent visibility and reduced direct sunlight  
 Tempered glass hinged window via tempered glass door to cockpit offers excellent ventilation and through flow  
 Laminate finishes with solid wood trim  
 Blinds covering port and starboard side windows  
 Overhead LED ceiling lights, LED mood lighting and LED courtesy lighting  
 Wall mounted LED lights  
 Panel ceilings with decorative solid wood trim and LED accent lighting  
 Comfortable open couch seating to starboard  
 U-shaped salon lounge settee around salon table with seating up to eight (8) people  
 Salon table  
 Large shelves behind settees  
 Cushions in soft easy clean upholstery  
 Hidden slide out mini bar in partition (4 cabin version only)  
 Bluetooth stereo head unit with DVD player  
 Four (4) ceiling mounted speakers 7.7" 200w

Salon converts into two (2) comfortable single beds  
 Vertical 316L stainless steel handrail in salon and galley  
 Synthetic flooring offering maintenance free natural look

## Galley Area

Three burner propane hob  
 Dedicated microwave storage location with outlet  
 Large double door fridge/freezer  
 Single stainless steel sink with Corian worktop cover and single lever variable temperature faucet  
 Central island with storage drawers underneath  
 Storage cupboards and drawers offering ample storage for all galley accessories  
 Durable stain resistant Corian countertop  
 Slide out garbage bin under sink  
 Overhead LED ceiling lights as well as mood lighting  
 LED courtesy floor lighting  
 Synthetic flooring offering maintenance free natural look

## Stateroom Areas

Large windows throughout offering excellent views  
 Dedicated hanging lockers  
 Custom blinds fitted on cabin hull windows  
 Concealed shade blind and insect screen on opening deck hatch where installed  
 Overhead LED ceiling lighting and floor courtesy lighting  
 Overhead LED reading lights  
 Aft starboard stateroom offering full size bed  
 Ample storage lockers and/or drawers under beds  
 150mm/6" memory foam mattresses  
 Synthetic wear resistant flooring offering maintenance free natural wood look  
 Large master stateroom mattress (60"W x 80" L / 195 cm x 203 cm)  
 Aft guest cabin mattress sizes (61.5"W x 79.8" L / 156 cm x 202 cm)

## Heads and Separate Shower Stalls

Quiet electric push button control fresh water flush toilets with large bowl  
 Opening deck hatch offering ample ventilation  
 Blinds over hull window  
 Stylish above countertop wash basins with single lever variable temperature faucet  
 Corian countertop surrounding wash basin  
 Vanity lockers with mirrors  
 Synthetic wear resistant flooring offering maintenance free natural wood look  
 Separate shower stall with seat and flexible shower faucet (except cabin 4 where shown)  
 Acrylic door separating shower from the rest of the bathroom (except cabin 4 where shown)  
 Automatic shower and sink drain via dedicated sealed sump box  
 Overhead LED lighting  
 LED nightlight above wash basin

## Navigation Area

Ample navigation work surface for charts and books  
 C-Zone digital switch panel with transfer switches for all electrical systems  
 Dedicated service panel for optional generator, desalinator and inverter control panels  
 Dedicated electronics display panel offering easy access and visibility to electronic systems including optional VHF radio  
 Multizone entertainment system master unit offering multi three (3) zone control  
 Light switch panel controlling all salon, galley and aft cockpit lighting  
 Remote battery switches for all onboard batteries

## Water and Bilge System

Fresh water pressure pumps with accumulator tank offering equal water pressure throughout  
 Backup fresh water pump  
 Two (2) hot water cylinders (80 L/21 gal) powered by engine heat exchanges and AC power  
 Two (2) connected water tanks (500 L/ 132 gal)  
 Water tank level gauges

## Waste System

Grey water from showers and sinks collected in two (2) sealed sump box's with auto discharge overboard  
 Black water holding tanks discharged via deck pump out or overboard with macerator pumps  
 Black water tank level gauges

## Electrical System

C-Zone digital switching system  
 Master control panel for 12v and shore power service  
 Remote battery master switches at panel  
 Five (5) house batteries 200 amp/hour, AGM technology in dedicated battery locker  
 Two (2) dedicated engine batteries 200 amp/hour, AGM technology  
 Shore side electrical system  
 AC power supplied by two (2) 50amp 125/250v shore power cables  
 Galvanic isolator protector system

## Fuel System

Diesel fuel system with Racor water separation filters  
 Dedicated fuel tank for each engine  
 Racor fuel filters for each engine  
 Aluminum fuel tanks with safety shut off valves and level monitors

## Safety

Automatic fire suppression heat activated system with alarm monitors  
 Bulbous bows integrated into hulls with sacrificial nose cone  
 Small safety bulkheads bonded in close to transom as a safety barrier  
 Owners operating manual  
 CE certification

## OPTIONAL LAYOUTS

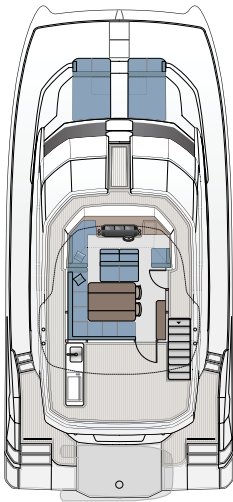

SKYLOUNGE FLYBRIDGE W/ NO INTERIOR STAIRS & STANDARD SEATING

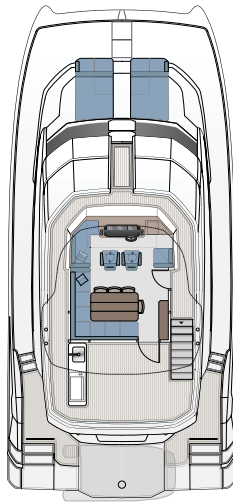

SKYLOUNGE FLYBRIDGE W/ NO INTERIOR STAIRS & CAPTAIN CHAIRS

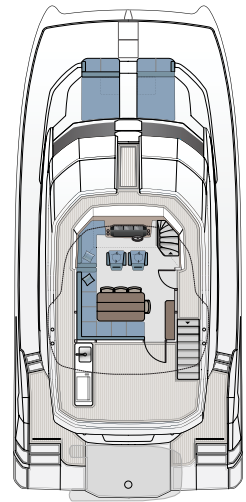

SKYLOUNGE FLYBRIDGE W/ INTERIOR STAIRS & CAPTAIN CHAIRS

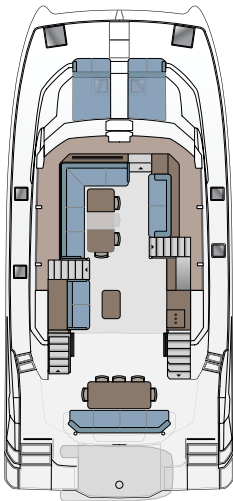

MAIN DECK W/GALLEY DOWN

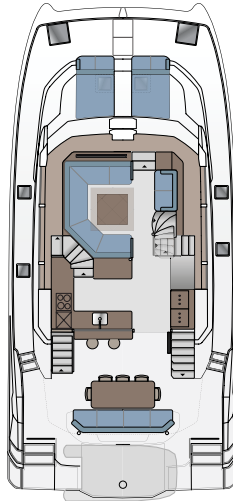

MAIN DECK W/INTERIOR SKYLOUNGE FLYBRIDGE STAIRS W/SKYLOUNGE

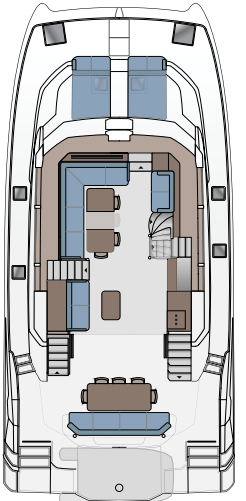

MAIN DECK W/GALLEY DOWN INTERIOR SKYLOUNGE FLYBRIDGE STAIRS

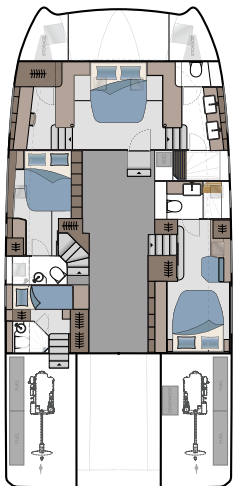

4-CABIN/4-HEAD

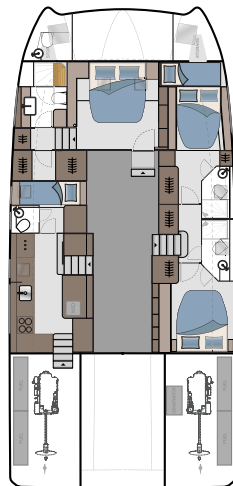

4-CABIN/4-HEAD GALLEY DOWN

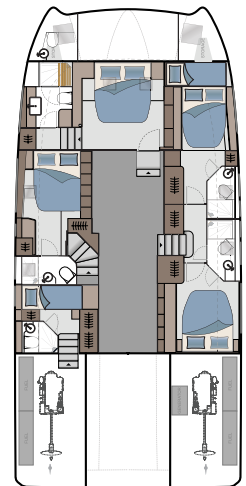

5-CABIN/5-HEAD



All specifications and options are subject to change by Sino Eagle Yachts at their sole discretion. Performance is purely indicative and not a contractual commitment. Performance is subject to many variances outside the control of Sino Eagle Yachts. Specifications and graphics in this brochure are non-binding and customer must enter into contractual agreement with the Dealer or Agent of Record.