

LEEN

T R I M A R A N S

LEEN⁷²



LEEN⁷²



LEEN⁷²

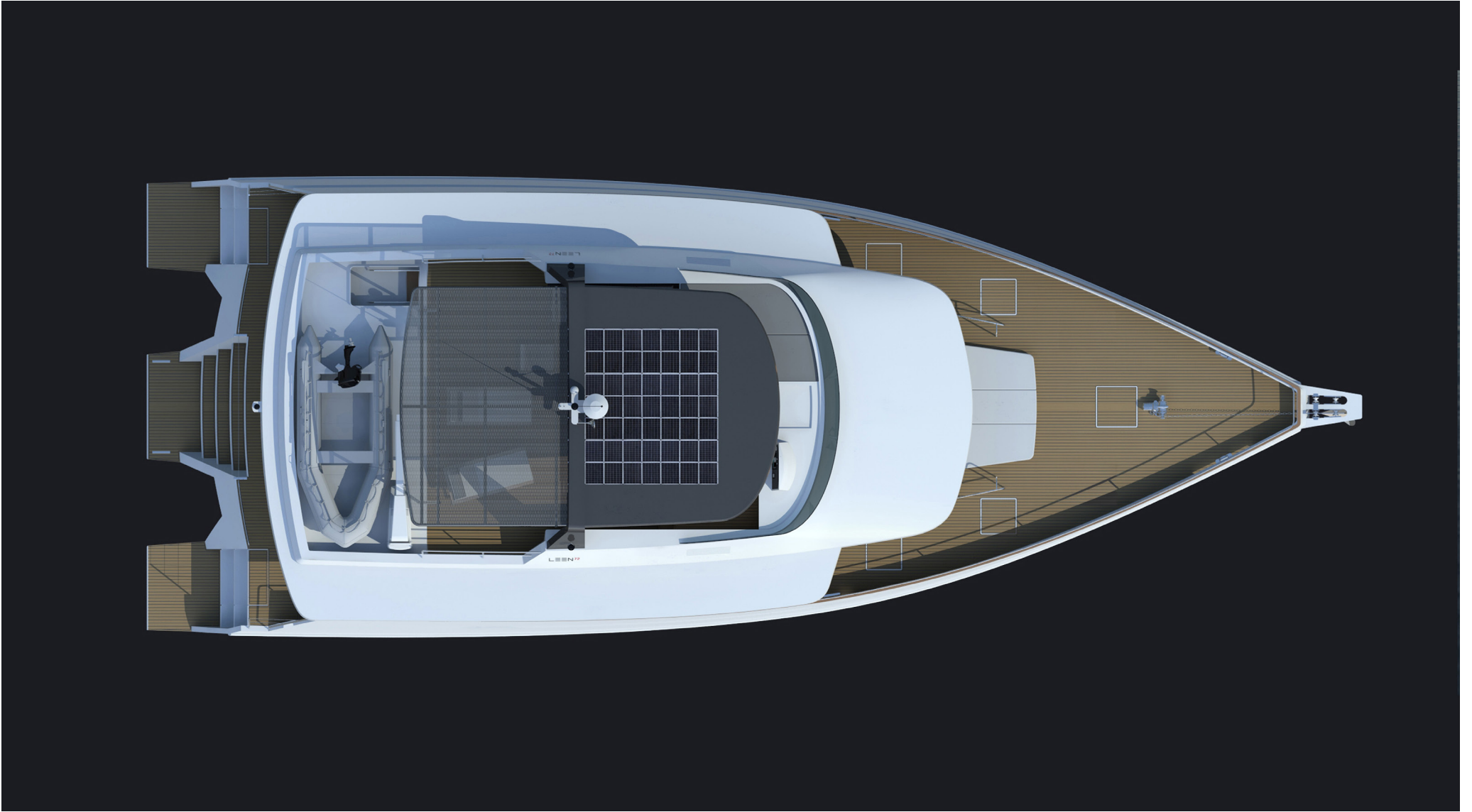

LEEN⁷²



LEEN⁷²



LEEN⁷²



LEEN⁷²



LEEN 72

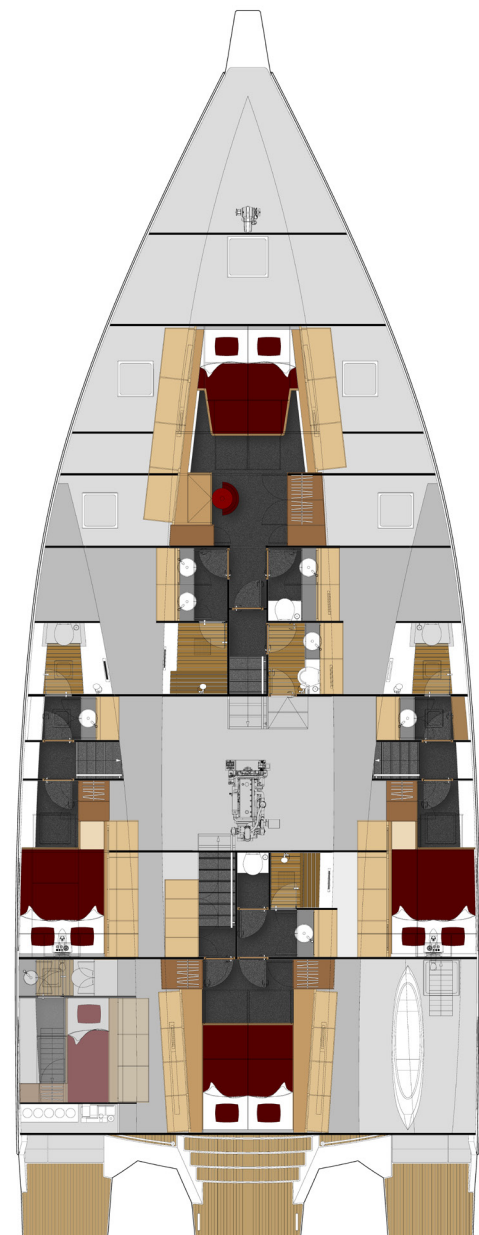
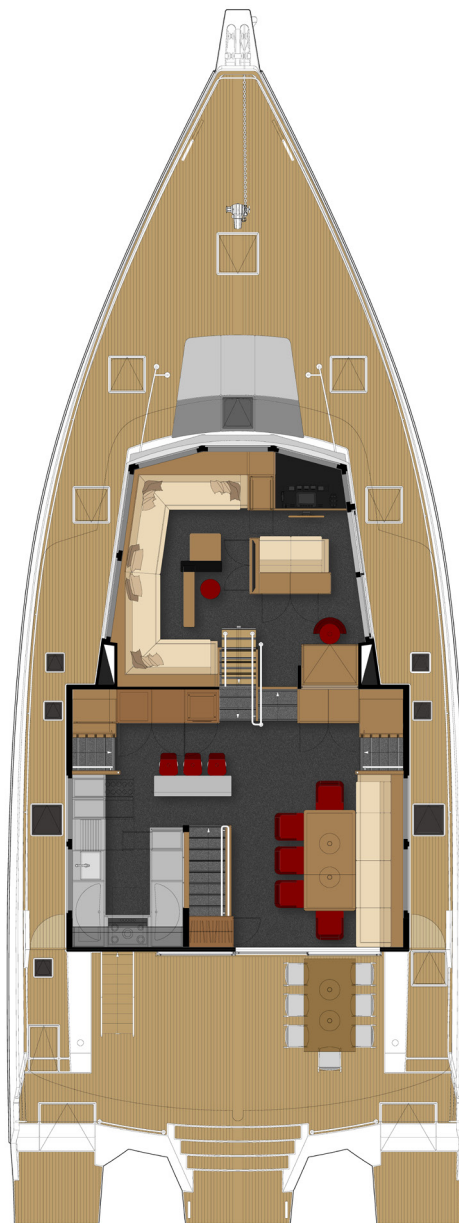
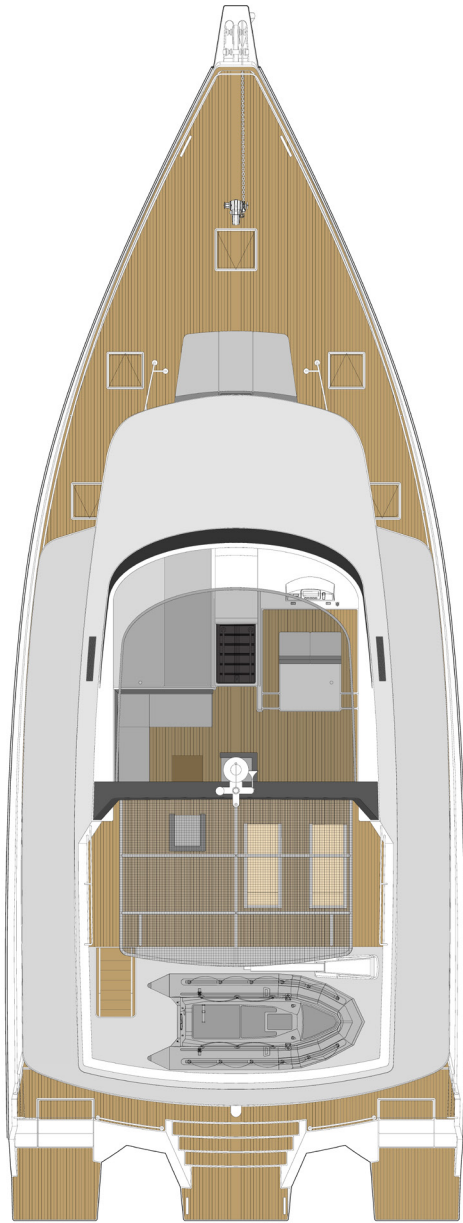

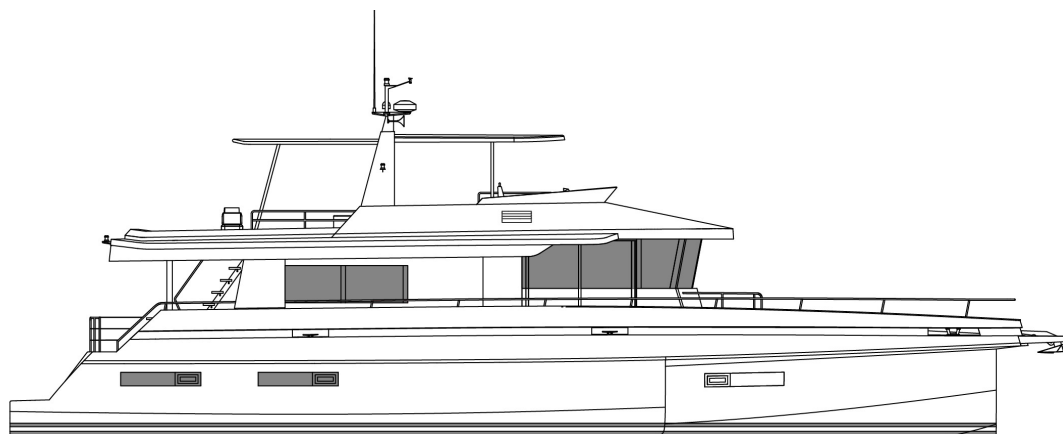

LEEN 72



Caractéristiques

Longueur HT 21,80 m

Largeur HT 8,85 m

Tirant d'eau 1,20 m

Poids lège 28 T (approx.)

Déplacement en charge maxi 38 T (approx.)

Réservoir de carburant 5 000 L

Réservoir d'eau 1 000 L

Motorisation À partir de 250 CV

Architectes Nivelt et Frutschi



Measurements

Overall length 72 ft

Overall beam 29 ft

Draft 4 ft

Displacement unloaded 28 metric Ton (approx.)

Full load displacement 38 metric Ton (approx.)

Fuel tank 1352 US G.

Water tank 263 US G.

Motorisation From 250 HP

Architectes Nivelt and Frutschi

LEEN 56



LEEN 56



LEEN 56

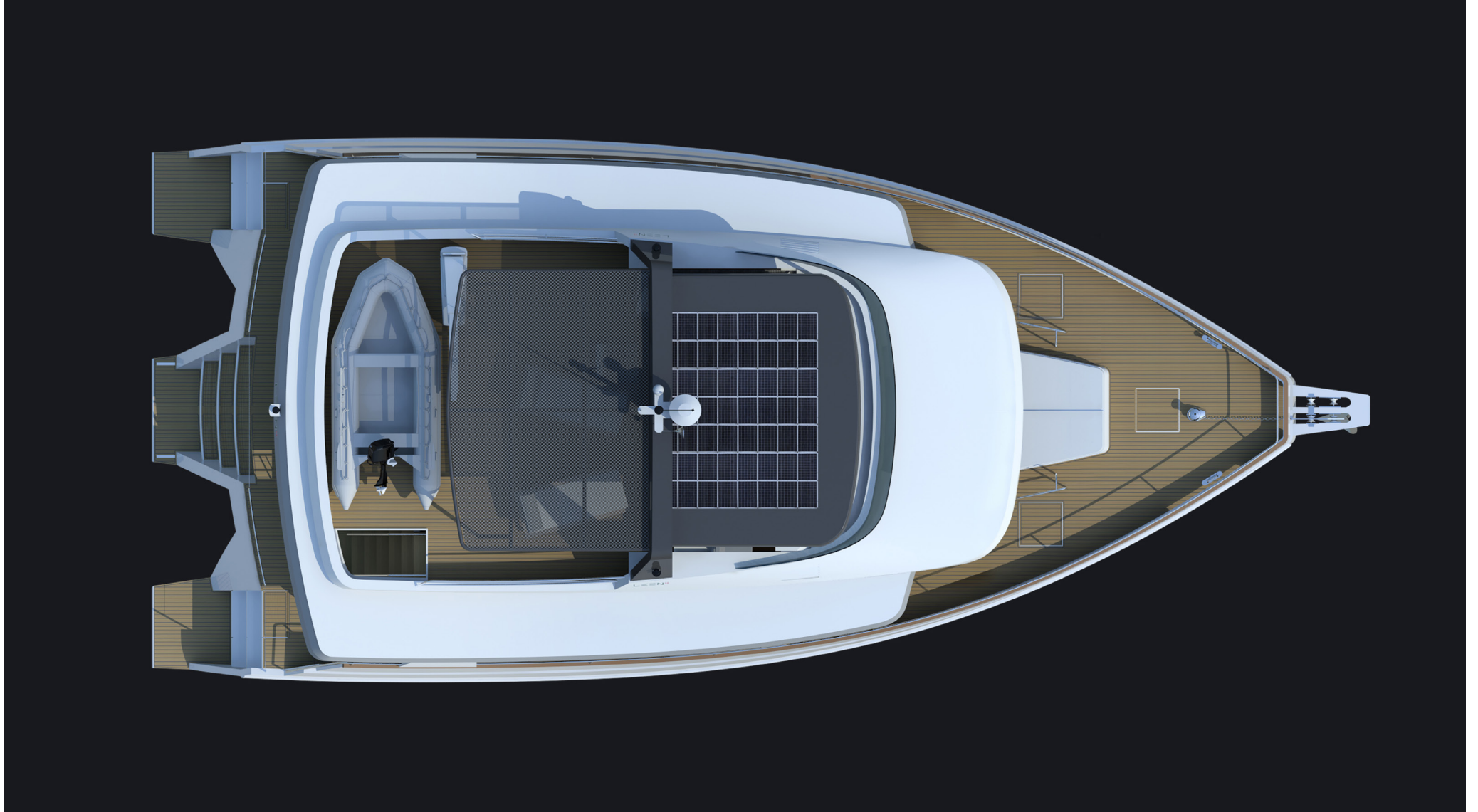

LEEN 56



LEEN 56



LEEN 56



LEEN 56

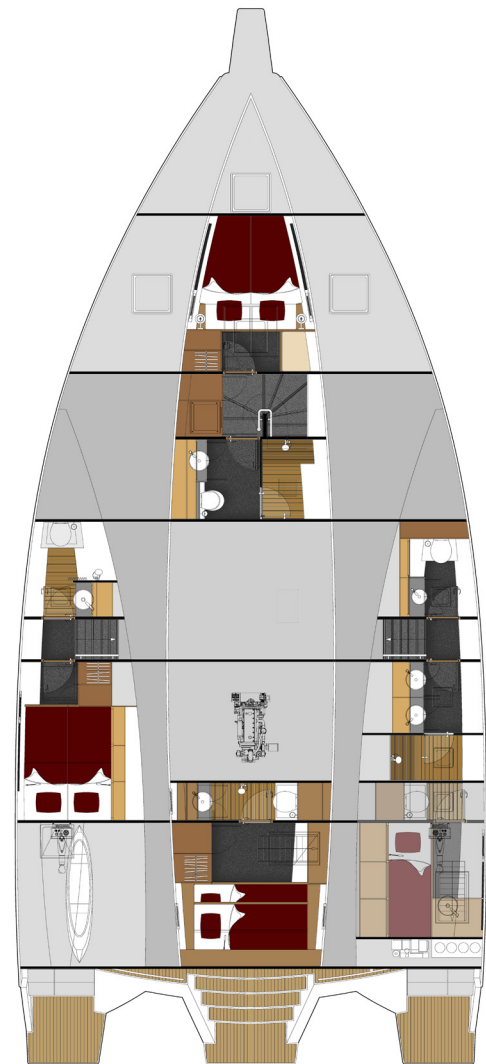
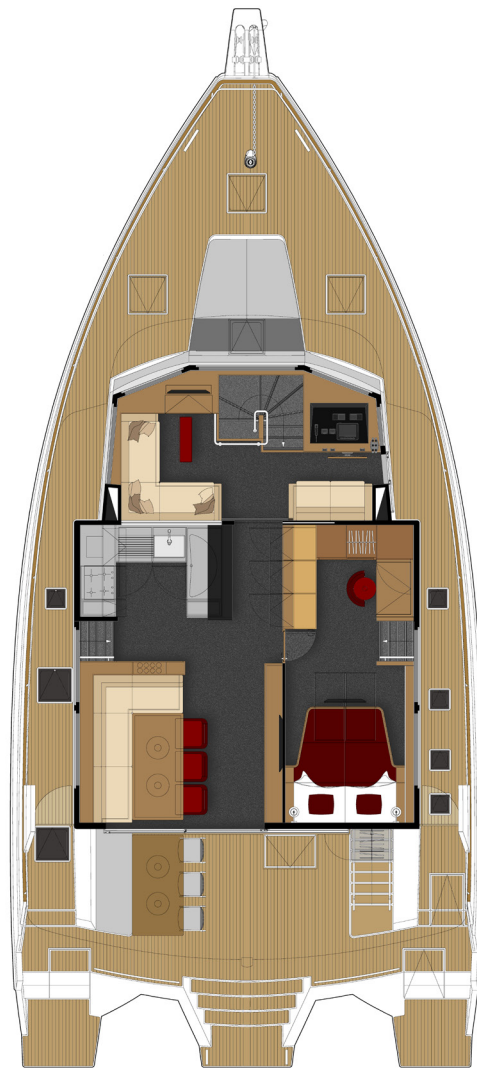
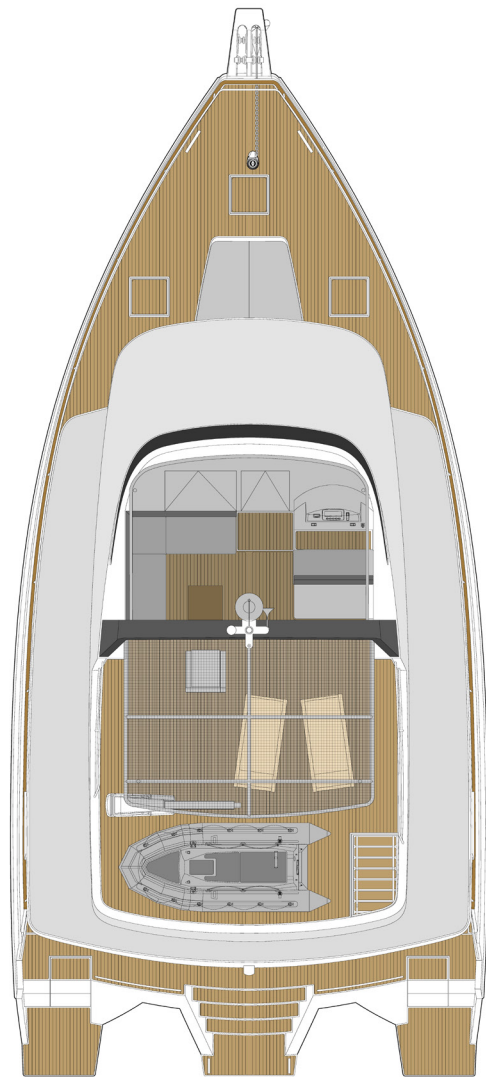

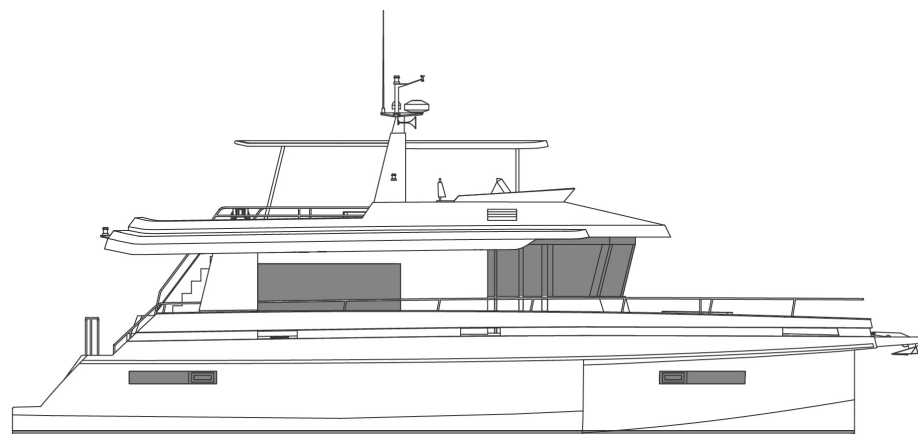

LEEN 56



Caractéristiques

Longueur HT 17,10 m

Largeur HT 8,25 m

Tirant d'eau 1,18 m

Poids lège 18 T (approx.)

Déplacement en charge maxi 26 T (approx.)

Réservoir de carburant 3 000 L

Réservoir d'eau 700 L

Motorisation À partir de 210 CV

Architectes Nivelt et Frutschi



Measurements

Overall length 56 ft

Overall beam 27 ft

Draft 3,85 ft

Displacement unloaded 18 metric Ton (approx.)

Full load displacement 26 metric Ton (approx.)

Fuel tank 790 US G.

Water tank 184 US G.

Motorisation From 210 HP

Architectes Nivelt and Frutschi

LEEN
T R I M A R A N S

+33(0)546 290 871

www.leen-trimarans.com

4 rue Virginie Hériot - Plateau nautique - BP 23085 - 17032 La Rochelle Cedex - France