



AZIMUT 78: SCULPTED BY MOVEMENT

The exteriors of the Azimut 78 Flybridge give the appearance of being sculptured out of pure movement. From stern to bow, from the sea to the sky, sculptural tension permeates the boat's contours.

The hull is testament to the constant quest for novel, innovative shapes. Advanced technological production techniques have enabled the designer to experiment with ribbed texturing and surface markings, with light and shade, where intertwined lines appear to extend towards infinity. The prow tapers to a sharp sliver whilst the prolonged lines of the bow meld seamlessly into those of the cover.

Fibreglass has been carefully fashioned to create a new concept in the sleek curves of the handrail while the windshield struts soar upwards to create a single frame which encircles the entire fly and continues upwards. The dark-coloured superstructure side supports herald a new stylistic approach. Boldly thrusting forward to support the fly, they remain unconnected yet create a horizontal angle which conceals the boat's dimensions and expresses its elegant yet sporty spirit.

With his creativity and innovative design, Alberto Mancini reinvents and embellishes the accepted shape and nature of a yacht. Through its dynamic lines, static elements become fluid, boat becomes sculpture and yachting is transformed into a form of visionary art.

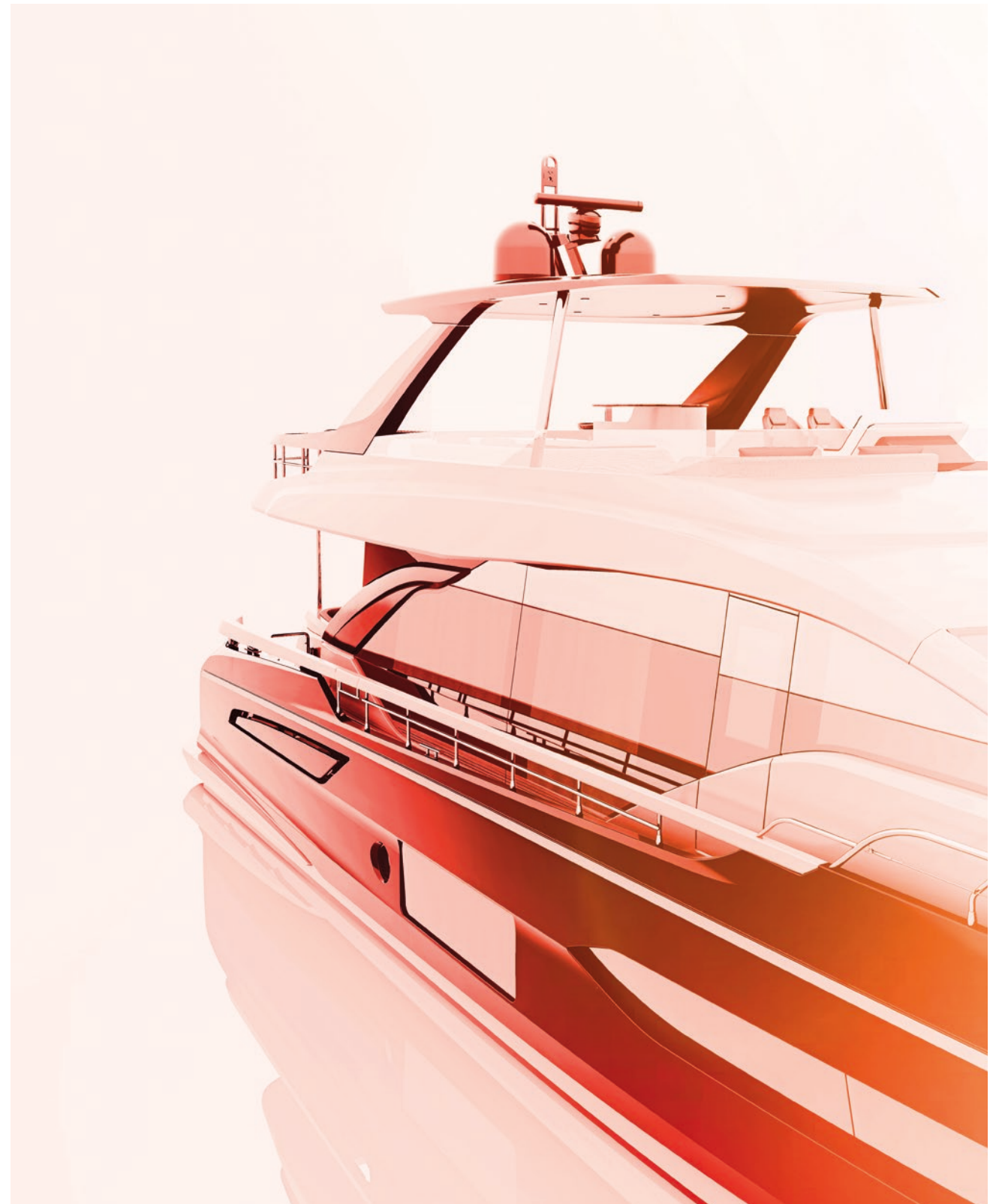









The spacious flybridge is a versatile space which offers a choice of layouts, allowing you to select the one which best suits your onboard lifestyle. Whilst the fore area contains a sun lounge next to the helm station, dining zone and L-shape wet bar, the stern section can be fitted with either an oversize sun pad, a roomy hot tub, a divan zone or a pair of chaise longue with a barbecue unit.





The hard top contains sliding panels for improved air circulation.





The spacious exterior areas are designed to foster conviviality and optimise connection with the sea, whatever the time of the day.

The roomy cockpit contains a comfortable dining zone whilst up front in the bow is a vast lounging area. With its large sundeck and facing divans it is the perfect spot for relaxing and soaking up the sun by day, enjoying an aperitivo during the balmy evenings and creating magical moments at sea.





Lounge version layout with informal dining.

In an original twist on the classic living area layout, the typical separation of sofa and dining area makes way for a single refined space decorated with care and style. In the absence of inside dining, there is ample space for two living areas but if needed, the coffee table can be raised to become a spacious dining table for eight. A more traditional layout with separated living and dining area is also available.





The elegant, original atmosphere of the interiors stems from the soft, curved lines synonymous with designer Achille Salvagni's approach. The charm of these spaces reflects his philosophy of creating flowing, contemporary dynamics, free from uninviting sharp, straight edges.



The owner's full-beam suite amidships has a separate dressing room and elegant vanity.



View of the owner's suite.







View of the bow VIP cabin.





The lower deck contains the owner's suite and three guest cabins, two of which are designated VIP, each with a double bed and large wardrobe, whilst the third has two singles. All cabins have an en suite bathroom.



The galley, adjoining the wheelhouse, also contains the crew mess and a stairway which leads directly to the crew quarters on the lower deck. It opens directly onto the side walkway whilst another door separates it from the saloon, creating a layout which offers complete independence for crew and an exceptional level of privacy for the owner and guests.











NEW AZIMUT 78

CARBON-TECH GENERATION

Carbon fiber is the design choice to provide increased volumes and extended surfaces within same weight ranges, granting excellent levels of static and dynamic stability.

Azimut Yachts is the first and only manufacturer in the marine industry to offer 11 models with extensive use of carbon fiber. 40% more is the estimated cost of same product in carbon fiber versus standard glass reinforced construction.

	 Carbon Fibre	 Hyrbrid Carbon Glass
Deck		
Superstructure		
Rollbar		
Hard Top (opt)		
Platform/Transom		



TECHNICAL CHARACTERISTICS

ТЕХНИЧЕСКИЕ ХАРАКТЕРИСТИКИ CARACTERÍSTICAS TÉCNICAS



Length overall (incl. pulpit)	23.64 m (77' 7")
Beam max	5.75 m (18' 10")
Draft (at full load)	1.77 m (5' 10")
Displacement (at full load)	62 t
Engines	3 x VOLVO IPS 1350 900 hp (662 kW)
Maximum speed	up to 33 knots
Cruising speed	up to 26 knots
Fuel capacity	5000 l (1321 US Gal)
Water capacity	1100 l (290 US Gal)
Cabins	4 + 1 crew
Berths	8 + 2/3 crew
Head compartments	4 + 1 crew
Building material	Carbon Fibre + GRP
Exterior styling & concept	Alberto Mancini
Interior Designer	Achille Salvagni Architetti
Builder	Azimut Yachts
Keel	Planing aft deadrise 16.3°

All performance specified in the table above are design data and apply to a standard configuration boat (standard equipment installed excluding tender, jet ski, etc.) with clean keel, propellers, and rudder. Furthermore, the performance levels indicated above have been defined under good sea and wind conditions (Beaufort Scale level 1, Douglas Scale level 1, ambient T < 25°, seawater T = 15°, atmospheric P = 103250 Pa) with 2 people on board, 25% fuel, and fresh, gray and black water tanks empty. Different or harsher sea conditions may significantly affect performance.

FLYBRIDGE

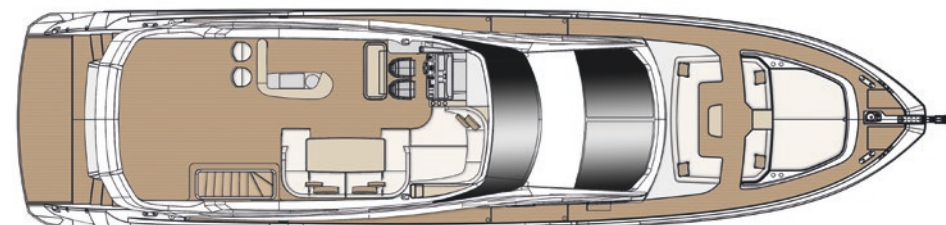

MAIN DECK

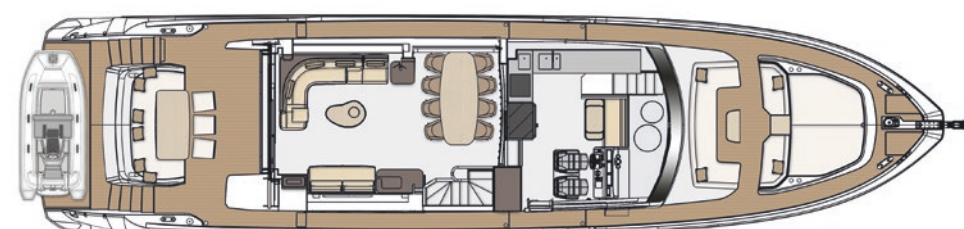

MAIN DECK - LOUNGE VERSION (OPT)

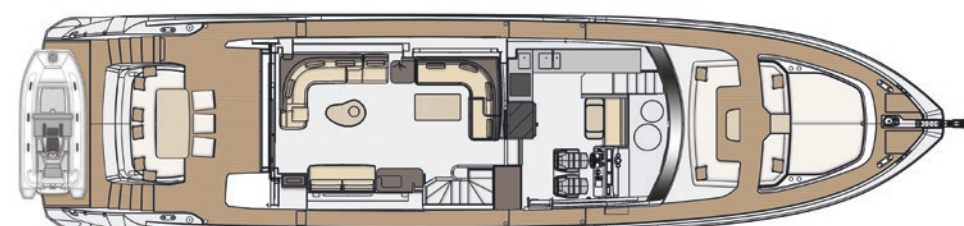

LOWER DECK

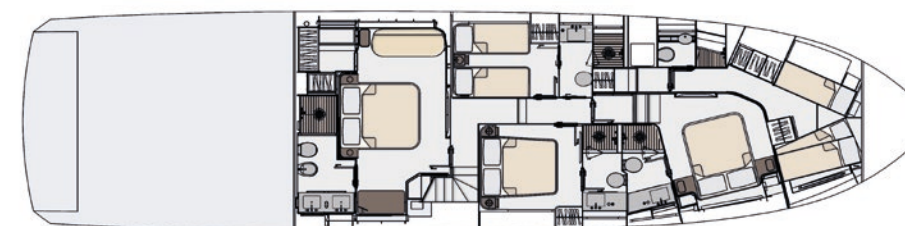



AZIMUT 78





Azimut | Benetti SpA

via Martin Luther King, 9 - 10051 Avigliana, Torino - Italy

azimutyachts.com

Last updated 1.09.2019. This brochure in no way constitutes a contract of sale for the boatyard's vessels to any person or company and is a preliminary brochure prepared in good faith according to the most recent Azimut's rendering referred to the yacht herein represented; therefore the final product could be different according to subsequent Azimut's adjustments and updates. All information contained herein, including but not limited to technical and performance data, illustrations, and drawings, is non-binding and for purposes of illustration only and may not be fully representative of final product. Optional equipment, not part of the standard base product, are depicted and may require separate order. The information in this brochure refers to the boatyard's standard motoryacht models available as of the date of publication. Technical and descriptive information is valid only to the extent that it pertains to the specific vessel that is the subject of a purchase. Contract terms are valid only to the extent that they are contained in a contract of sale. This document is based on information available at the time of publication. Despite efforts to ensure the greatest possible accuracy, the information contained herein may fail to cover all details, omit technical or commercial changes that may have been made subsequent to publication, describe features that are not present, and fail to envisage all circumstances that might occur. Any illustrations, photographs, diagrams and examples shown in this brochure are included solely for illustrative purposes. Due to the different features of each vessel, the boatyard assumes no liability for actual use based on the illustrated applications.

