



YACHTS FOR SALE

**Azimut S6**

YEAR  
**2023**

LENGTH  
**18.00 m**

  
**AZIMUT**  
YACHTS  
MONTENEGRO

# Azimut S6

YEAR  
2023

LENGTH  
18.00 m

VAT EXCLUDED | WITHOUT OPTIONS  
By request

Length overall	18.00 m
Beam overall	5.00 m
Draft	1.61 m
Material	GRP   Carbon fiber
Cabines	3 + 1
Head compartments	2 + 1
Engine	3 x VOLVO IPS 700 D8 550 h.p.
Fuel capacity	2600 l
Water capacity	590 l
Max speed	35.00 knots
Cruising speed	30.00 knots
Range	275 nm
Location	Italy

The company is not liable for validity of the information provided by the yacht-owner (images, specification of the yacht, list of equipment installed, its operability, engine hours, legal aspects). Actual engine hours are indicated at the moment of initial information placement and gets further periodically updated. Detailed information and characteristics will be provided on buyer's request and indicated in the contract.





Exterior Azimut S6

Exterior Azimut S6







Exterior Azimut S6

Exterior Azimut S6. SportFly Version







Exterior Azimut S6. SportFly Version

Sunbed area on bow





Sunbed area on aft cockpit

Cockpit







Cockpit

Saloon at main deck





Saloon at main deck

Main helm station







Galley

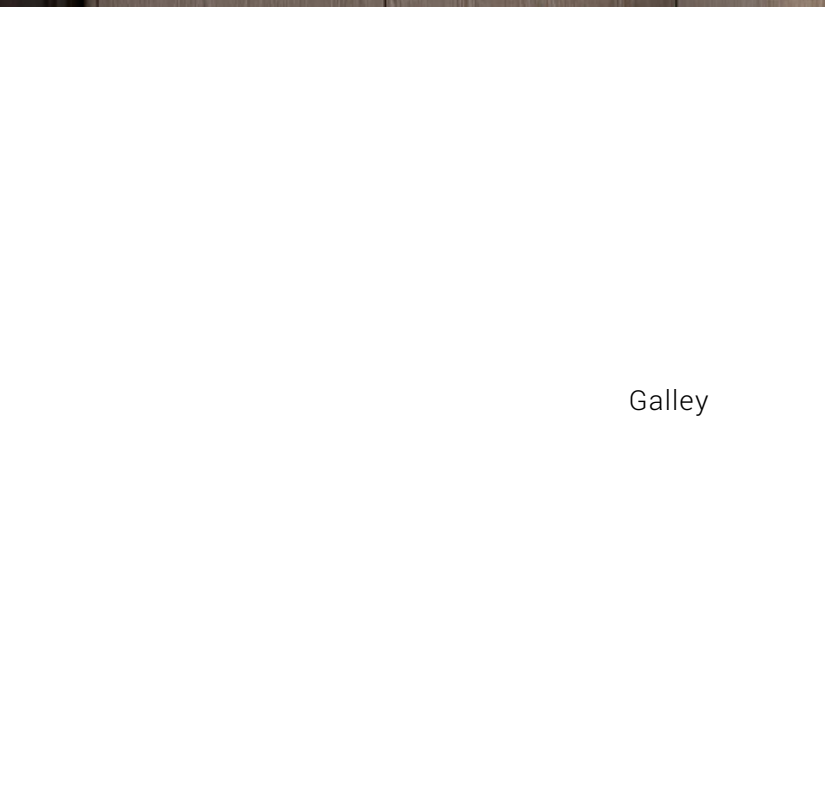

Galley





Master cabin

Master cabin







Master cabin

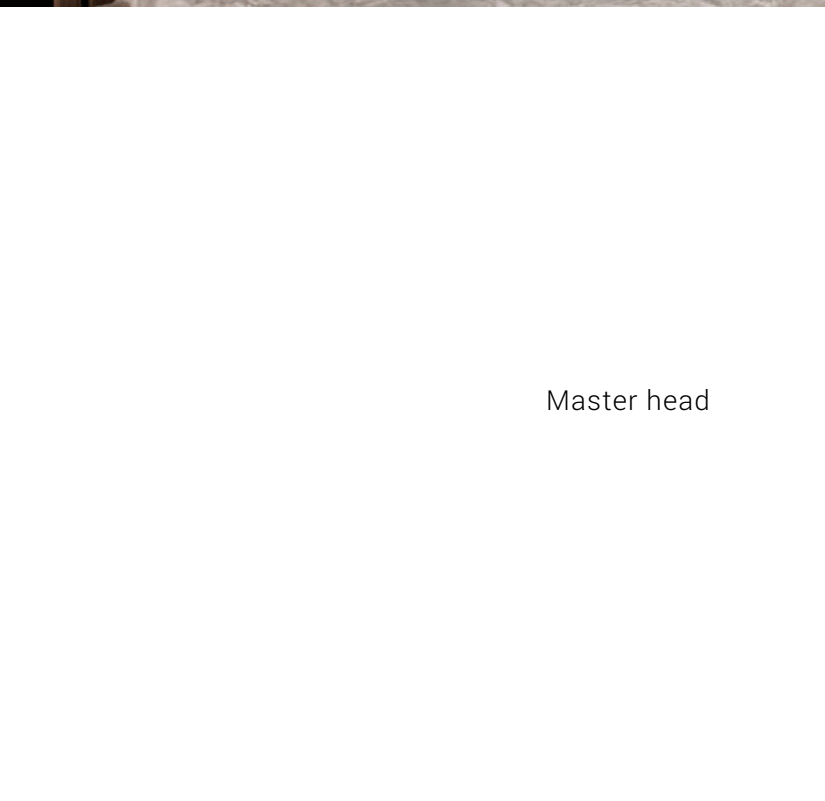

Master head





VIP cabin

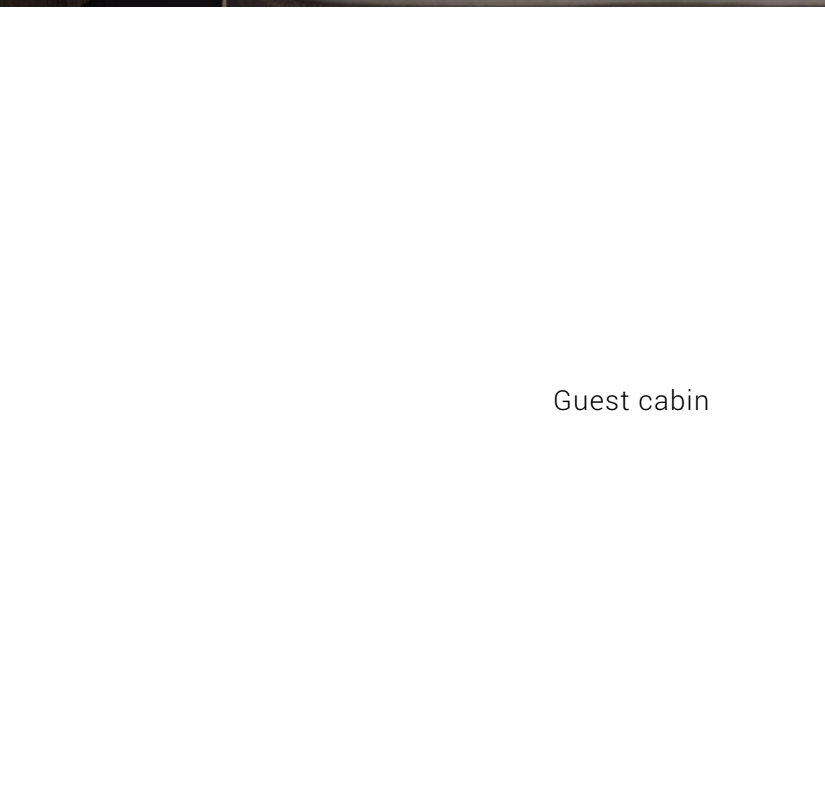

Guest cabin





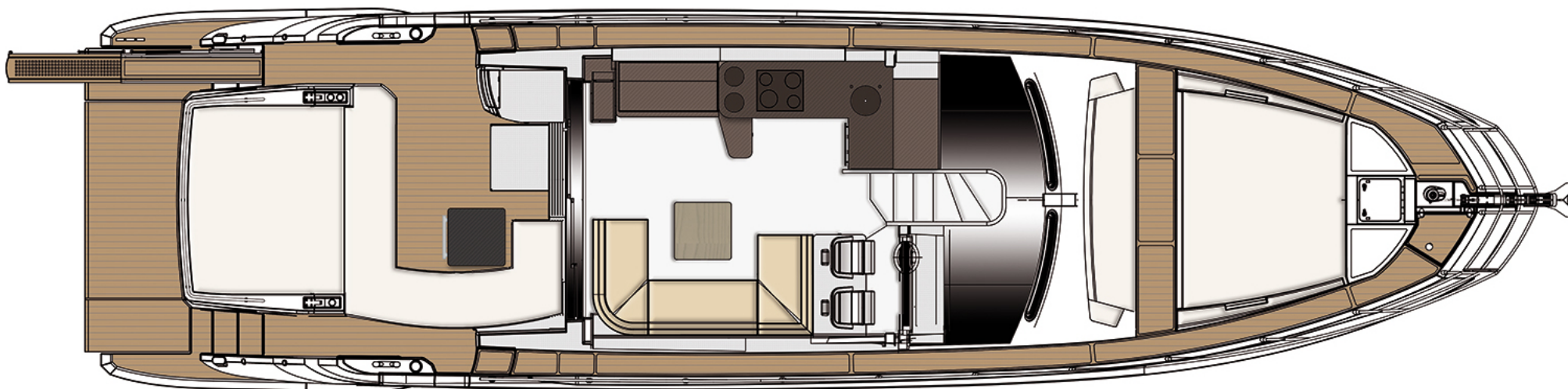

Main deck

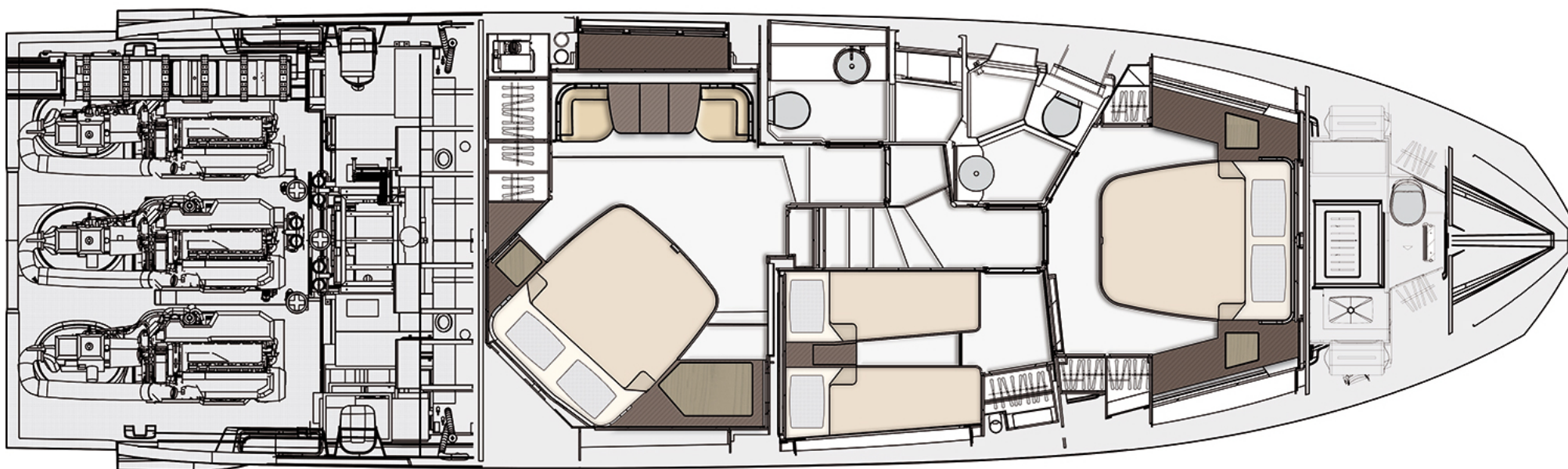

Lower deck



Azimut S6

YEAR  
2023

LENGTH  
18.00 m

VAT EXCLUDED | WITHOUT OPTIONS  
By request

SPECIFICATIONS

Length overall	18.00 m	Beam overall	5.00 m
Draft	1.61 m	Material	GRP   Carbon fiber
Passenger capacity	12	Berths	6 + 1
Cabines	3 + 1	Head compartments	2 + 1
Engine	3 x VOLVO IPS 700 D8 550 h.p.	Fuel capacity	2600 l
Water capacity	590 l	Holding tank capacity	175 l
Grey water capacity	175 l	Max speed	35.00 knots
Cruising speed	30.00 knots	Range	275 nm
Displacement	29.50 t	Interior designer	Francesco Guida
Exterior styling & concept	Stefano Righini	Keel	Deadrise 15.5° transom and 21.2° amidship

The company is not liable for validity of the information provided by the yacht-owner (images, specification of the yacht, list of equipment installed, its operability, engine hours, legal aspects). Actual engine hours are indicated at the moment of initial information placement and gets further periodically updated. Detailed information and characteristics will be provided on buyer's request and indicated in the contract.

	YEAR	LENGTH	VAT EXCLUDED   WITHOUT OPTIONS
Azimut S6	2023	18.00 m	By request

STANDART SPECIFICATION

Bow and walk aroundsBow

- Anchor chain housing
- 75-meter high-resistance gaged chain, diameter 10mm
- 1700 W winch
- 2 cleats (one per side)
- Bow hatch (emergency exit) from VIP cabin on fore sunbed area

Walk arounds

- Refueling plugs -1 plug per side
- Black tank discharge outlets -1 "Waste" water outlet plug without cover, starboard side
- Stainless steel pulpit
- Fiberglass boarding gates

Cockpit and platformCockpit

- Aft access via two passages. Main on port side with gangway and on starboard side for access to walk around.
- Cockpit "C" shaped sofa provided with fenders, storage, and life raft lockers
- Cup holder on the right and left sides of the sunbed area
- Saloon access door with 4 aluminum panels, 2 of which of the sliding type
- Mooring stations with mushroom-shaped cleats and stainless steel chocks
- Fire extinguisher controls with protective Plexiglas door

- DELTA 25 kg anchor
- Stainless steel anchor roller
- Chain washing pump system with direct water jet on the chain
- Sunbed area with two handrails and sofa facing the bow, with side glass racks
- Entrance of optional crew cabin
- Fresh water filling -1 "Water" cap without cover, port side
- 2 intermediate cleats, one on each bulwark
- Rubber rub-rail with knurled stainless steel section
- GRP non-slip floor (knurled)
- Steel aft gates (2)
- Engine compartment access through dedicated engine room hatch
- Separate sunbed area with storage under the cushion, fender storage and/or cockpit seat
- Perimeter grabrails on cockpit sunbed area and on the sides of aft accesses
- Teak floor
- Lockers below the mooring stations (1 per side)



	YEAR	LENGTH	VAT EXCLUDED   WITHOUT OPTIONS
Azimut S6	2023	18.00 m	By request

- Emergency panel-battery cut-out with controls for: battery cut-out (service, engine and generator)

**Platform and garage**

- Shore power socket on the starboard side of the top step, protected by a cover
- External shower on port side
- Walkway lights on the steps of the cockpit access ladder
- Garage with bottom pre-arranged for engine unloading
- The garage is sized to store a Pirelli J33
- Platform GRP non-slip floor (knurled)

**Wheelhouse**

- Helm seat located on storage cabinet
- Steering wheel
- - Engine control instrumentation on Volvo 7" display with built-in automatic pilot and trip computer
- - Communication systems (VHF)
- - Volvo Penta engine throttles, with sin-gle lever, manual interceptors and LOW SPEED
- - USB socket
- - Adjustable air conditioning outlets (x2)

**Saloon / Dinette and GalleySaloon and Dinette**

- LED lighting on ceiling

- 2 handrails on sides of boarding gates
- Manual telescopic swimming ladder on port side
- Aft rub-rail with stainless steel insert
- Courtesy light inside the garage
- Platform with tenderlift system (max load 600 kg)
- Platform dimensions: 1120 x 3060mm

- Electrically openable window
- Internal dashboard consisting of:
  - - BRONZE PACKAGE electronic navigation instrumentation (chartplotter with integrated monitoring system and water temperature, depth, speed, and chain length reading)
  - - Magnetic compass
  - - Volvo Penta maneuvering joystick with joystick driving
  - - Horn, anchor winch, chain washing pump, windscreen wipers, windshield washers, engine battery parallel, and MUTE activation switches
  - - Emergency panel

# Azimut S6

YEAR  
**2023**

LENGTH  
**18.00 m**

VAT EXCLUDED | WITHOUT OPTIONS

**By request**

- Openable hard top with GRP panels and controls in wheelhouse
- Fix dining table
- Provision for TV system with aerial
- Ceiling panels and wall upholstery in faux leather
- LED lighting

## Galley

- Positioned on port side
- 20-liter microwave oven
- Drawer-type fridge 144 l
- Hood

- "C"-shaped sofa on starboard side of the saloon
- Saloon door blind
- Stainless steel handrail at top of stairs leading down to the cabins
- Carpeted floor

- 4-hob range
- 1 stainless steel sink
- Drawer-type freezer 42 l
- Garbage can

## Owner's cabin

- Located midship
- Mattress, pillows
- Manually openable double bed; storage underneath
- Vanity table with 2 armchairs on the left side
- Rectangular hull windows
- 1 mirror in cabin
- Bulwark upholstery in faux leather
- Carpeted floor

- Wood essence furniture
- Diagonal double bed with headboard on starboard side
- Shelf beside the bed
- 2 openable portlights, one perside (rectangular portlight inserted in the window)
- 1 mirror on the vanity table
- Aluminum Venetian blinds on the windows
- Ceiling panels in faux leather

The company is not liable for validity of the information provided by the yacht-owner (images, specification of the yacht, list of equipment installed, its operability, engine hours, legal aspects). Actual engine hours are indicated at the moment of initial information placement and gets further periodically updated. Detailed information and characteristics will be provided on buyer's request and indicated in the contract.



# Azimut S6

YEAR  
2023

LENGTH  
18.00 m

VAT EXCLUDED | WITHOUT OPTIONS

By request

- 2 wall lights on headboard
- Sockets
- Lighting with LED spotlights and strips
- Direct access to owner's head

## Owner's head

- Located forward of the owner's cabin, on port side
- Washbasin resting on top
- TECMA toilet
- Shower column and seat in metallic black ABS
- 1 openable portlight with aluminum Venetian blind
- Forced extraction
- 2 clothes hooks
- 1 toilet roll holder
- LED lighting

## Guest cabin

- Located on starboard side
- 1 central bedside table between the beds
- 1 openable round portlight
- Ceiling with faux leather panels

- Walkwaylights on the cabin accesss teps
- Provision for TV system with aerial
- Engine room side sound-proofing

- Access from owner's cabin
- Chromed mixertap
- Separate shower enclosure
- Wall unit with folding panel above the washbasin top
- Wood floor with anti-slip treatment
- 1 toilet brush holder
- 1 soap dispenser
- 1 towel rail

- 2 single beds, flat, fixed, with lockers below
- 1 wardrobe with hanger bar and shelves
- Aluminum Venetian blind

The company is not liable for validity of the information provided by the yacht-owner (images, specification of the yacht, list of equipment installed, its operability, engine hours, legal aspects). Actual engine hours are indicated at the moment of initial information placement and gets further periodically updated. Detailed information and characteristics will be provided on buyer's request and indicated in the contract.

# Azimut S6

YEAR  
2023

LENGTH  
18.00 m

VAT EXCLUDED | WITHOUT OPTIONS

By request

- Bulwark upholstery in faux leather
- Wall lights on headboard

## VIP cabin

- Located at the bow
- Mattress, pillows
- 2 wall units above the side windows
- 1 wardrobe on starboard side
- Shelf on the sides of the bed, against the bulwark
- Fixed panoramic windows
- Aluminum Venetian blinds on the windows
- Ceiling with faux leather panels
- Sockets
- LED lighting

## VIP / Guest heads

- Positioned abaft of the VIP cabin, on port side
- Washbasin resting on top
- Separate shower
- Wall unit, 1 panel
- Forced extraction

- Carpeted floor
- LED lighting

- Wood essence furniture
- Manually openable double bed; storage underneath
- 1 wardrobe on port side
- 1 mirror in cabin
- 2 openable round portholes
- Rectangular hatchway leading onto fore sunbed area
- Bulwark upholstery in faux leather
- Carpeted floor
- 2 wall lights on headboard
- Direct access to VIP head

- TECMA toilet
- Chromed mixertap
- Column in metallic black ABS
- Wood essence floor

The company is not liable for validity of the information provided by the yacht-owner (images, specification of the yacht, list of equipment installed, its operability, engine hours, legal aspects). Actual engine hours are indicated at the moment of initial information placement and gets further periodically updated. Detailed information and characteristics will be provided on buyer's request and indicated in the contract.



# Azimut S6

YEAR  
**2023**

LENGTH  
**18.00 m**

VAT EXCLUDED | WITHOUT OPTIONS

**By request**

- 1 round openable portlight with aluminum Venetian blind
- 2 clothes hooks
- 1 toilet roll holder
- LED lighting

## Crew cabin (OPT)

- Fore access through rectangular hatch with key lock
- 1 single tip-up bed
- 2 wardrobes (1 on each bulwark)
- Spotlights lighting

## Crew head (OPT)

- TECMA toilet
- Shower grating

## Electric systemMain characteristics

- The voltage levels on board are: 220V - 50 HzA.C./24V(12VforVHFequipment and cigarette lighter socket)
- 1 QDC3 = Folding panel, guest cabin
- 1 QAC2 = Support distribution board 220V Folding panel, guest cabin
- 1 HPDC = Utilities panel 24V DC Port cabinet at saloon entrance
- Volvo 24V manual trim correctors (in-truder)

- 1 toilet brush holder
- 1 soap dispenser
- 1 towel rail
- Direct access from the VIP cabin or from the corridor

- Located in the fore part of the boat
- 1 openable round portlight on starboard side
- 2 flexible removable bags
- 1 Socket

- Shower with anti-spray curtain
- Washbasin with flexible hose tap for shower

- 1 QDC1 = Distribution board 24V DC, engine room
- 1 QDC2 = Auxiliary distribution board 24V DC, engine room
- 1 QAC1 = Main board 120/230V AC, engine room
- 1 HPAC= Utilities control panel 120/230 V AC Port cabinet at saloon entrance
- Steering system = electric, integrated in the IPS drive

The company is not liable for validity of the information provided by the yacht-owner (images, specification of the yacht, list of equipment installed, its operability, engine hours, legal aspects). Actual engine hours are indicated at the moment of initial information placement and gets further periodically updated. Detailed information and characteristics will be provided on buyer's request and indicated in the contract.

# Azimut S6

YEAR  
2023

LENGTH  
18.00 m

VAT EXCLUDED | WITHOUT OPTIONS  
By request

- Cockpit utilities panel:
- - Engine 1 battery cut-out button
- - Engine 3 battery cut-out button

**Galvanic current system**

- zinc cathodes

**Generator**

- A 3.5 kW - 220V / 50 Hz generator is provided

**Shore power sockets**

- 1 service socket 220V- 50A

**Batteries**

- Services: 6 connected batteries, each delivering 12V 90 Ah
- Generator: 1 battery delivering 12V 70 Ah
- 12A electronic battery charger- generator (220/110V)

**Electronic navigation instrumentsWheelhouse**

- Raymarine Bronze Package

**Bilge system**

- 3 automatic 24V motor pumps (2 in engine room, 1 in owner's cabin) with bulwark outlet
- level alarms on alarm display

- - Service battery cut-out button
- - Engine 2 battery cut-out button
- - Generator battery cut-out button

- Volvo ACP (Active Corrosion Protection system)

- Engines: 6 batteries (2 for each engine), each delivering 12V 70 Ah
- 60A electronic battery charger-services (220/110V)
- 30A electronic battery charger- engines (220/110V)

- 2 manual emergency pumps; 1 in engine room and 1 in owner's cabin, with bulwark outlet

The company is not liable for validity of the information provided by the yacht-owner (images, specification of the yacht, list of equipment installed, its operability, engine hours, legal aspects). Actual engine hours are indicated at the moment of initial information placement and gets further periodically updated. Detailed information and characteristics will be provided on buyer's request and indicated in the contract.



# Azimut S6

YEAR  
**2023**

LENGTH  
**18.00 m**

VAT EXCLUDED | WITHOUT OPTIONS

**By request**

## Fire extinguishing system

- System with pull handle in cockpit and 1 gas tank (RINA type-approved)

## Fuel system

- 2 aluminum tanks, 1300 l each, total 2600 l.
- Optical fuel level gage on port tank in engine room
- 1 filterfor generator
- 2 vents on bulwark
- Pipe connecting the two tanks to adjust the fuel level
- Electronic level gage
- 3 single settling filters foreengines
- 2 refueling plugs on walk arounds, 1 per side
- Remote diesel shut-offvia solenoid valve (24V for engine and 12V for generator)
- Fuel drawing tap

## Fresh water system

- A 590-liter polyethylene tank beneath the floor of the cabin access corridor
- Level sensor with electronic gage in wheelhouse
- Pressure pump
- Water filling from bow (port side)
- 1 tank vent on port bulwark
- 60-liter water heater

## Black water system

- 1 175 l tank in polyethylene under VIP cabin's floor
- 1 tank vent with anti-odor filter on starboard bulwark
- Suction point from deck walk around (starboard side)
- Tecma toilet (with macerator pump). All the toilets discharge into a tank (including the crew cabin toilet, if envisaged)
- Level sensor
- 1 macerator pump under guest cabin floor
- Outboard discharge under VIP cabin bed
- Tank washing system with fresh water

## Gray water system

- 1 175 l polyethylene tank beneath the floor of the cabin access corridor

The company is not liable for validity of the information provided by the yacht-owner (images, specification of the yacht, list of equipment installed, its operability, engine hours, legal aspects). Actual engine hours are indicated at the moment of initial information placement and gets further periodically updated. Detailed information and characteristics will be provided on buyer's request and indicated in the contract.

YEAR  
2023LENGTH  
18.00 m

VAT EXCLUDED | WITHOUT OPTIONS

Azimut S6

By request

- Level sensor with alarm indicator on the wheelhouse
- Membrane pump below guest cabin floor

**Seawater system**

- Engine cooling system: 3 dynamic seawater intakes in the keel with ball valve located forward of the respective engines
- Air conditioning cooling system: submerged outlet: 1 dynamic seawater intake (1" 1/4) with filter and valve

**Ventilation**

- Head ventilation: 24V forced suction in owner and VIP heads
- -Natural air intake through hull bulwark intake (1 per side)

**Engine room (other)**

- Engine compartment access via hatch in cockpit

**Air conditioning system (OPT)**

- 1 compressor in engine room (total 72 kBTU)
- Distribution:
  - - Wheelhouse 16000 BTU
  - - VIPcabin 12500 BTU
  - - Crew cabin 4480 BTU
  - - A/C cut-out in guest head

**Equipment**

- Automatic/manual water discharge

- Generator cooling system: submerged outlet: 1 dynamic 1" seawater intake with filter and valve
- Chain washing pump: seawater

- Engine room:
  - -Forced extraction: with 2 24V extractors, diam 305 mm (1 per side)

- 1 seawater pump with relevant seawater intake in engine room
- - Saloon + Galley + Dinette 1 x 12500 BTU + 14800 BTU
- - Owner's cabin 12500 BTU
- - Guest cabin 6200 BTU
- - A/C cut-out in owner's head

The company is not liable for validity of the information provided by the yacht-owner (images, specification of the yacht, list of equipment installed, its operability, engine hours, legal aspects). Actual engine hours are indicated at the moment of initial information placement and gets further periodically updated. Detailed information and characteristics will be provided on buyer's request and indicated in the contract.



# Azimut S6

YEAR  
**2023**

LENGTH  
**18.00 m**

VAT EXCLUDED | WITHOUT OPTIONS

**By request**

- 1 telescopic boat hook
- 24 m fender lines
- 8 black fender covers
- 1 AZIMUT document holder
- 1 AZIMUT warranty service booklet
- 1 set of china plates
- 1 set of stainless steel cooking pans
- 4 floating key-rings
- 1 remote control holder (with logo)
- 1 routine maintenance kit for steel

- 5 anchor lines
- 8 fenders
- 1 Owner's Manual
- 1 wooden model of the boat
- 1 stainless steel cutlery service
- 1 set of glasses
- 2 sets of towels (with logo)
- 1 bag (with logo) for storing the manuals
- 1 bag forholding the shower tube

The company is not liable for validity of the information provided by the yacht-owner (images, specification of the yacht, list of equipment installed, its operability, engine hours, legal aspects). Actual engine hours are indicated at the moment of initial information placement and gets further periodically updated. Detailed information and characteristics will be provided on buyer's request and indicated in the contract.